

# Ford Ranger US-Version-2019 4WD Front 6 Pot Brake Kit

## INSTALLATION DIRECTION (LEFT HAND SIDE)

REF	DESCRIPTION	QTY
1	Slotted Rotor $\phi$ 356mm ( 6560095SGL )	1
1	Slotted Rotor $\phi$ 356mm ( 6560095SSGR )	1
2	Banjo Bolt	2
3	Copper Gasket	4
4	Brake Hose (LH) 692023	1
4	Brake Hose (RH) 692023	1
5	Caliper Bolt (M12-L65)	4
6	Spring Washer (TH. = 3mm)	4
7	Caliper Assembly	2
8	Caliper Bleed Screw	4
9	Caliper Bracket Connecting Bolt (M14-P1.5)	O.E.
10	Adjusting Washer (M14-TH. 0.5mm)	8
11	Washer (M14-TH. 2.5mm)	4
12	Brake Pad ( 6820022X )	1 SET
13	Tension Spring	2
14	Retainer	4
15	Retainer Fixed Bolt	4
16	Retainer Fixed Nut	4
17	Caliper Bracket	2
18	Ball Joint Heat Protection Plate	2
19	Ball Joint Fixed Bolt	O.E.
20		
21		
22		
23		

### Tightening Torques

REF #	Torque (N-M)
2	25~27
5	65~68
8	7
9,19	O.E.STD.
15,16	17

### Brake Rotor Wear

New Min

Thickness 32 mm 30 mm

### Brake Pad Wear

New Thickness 16mm 8mm

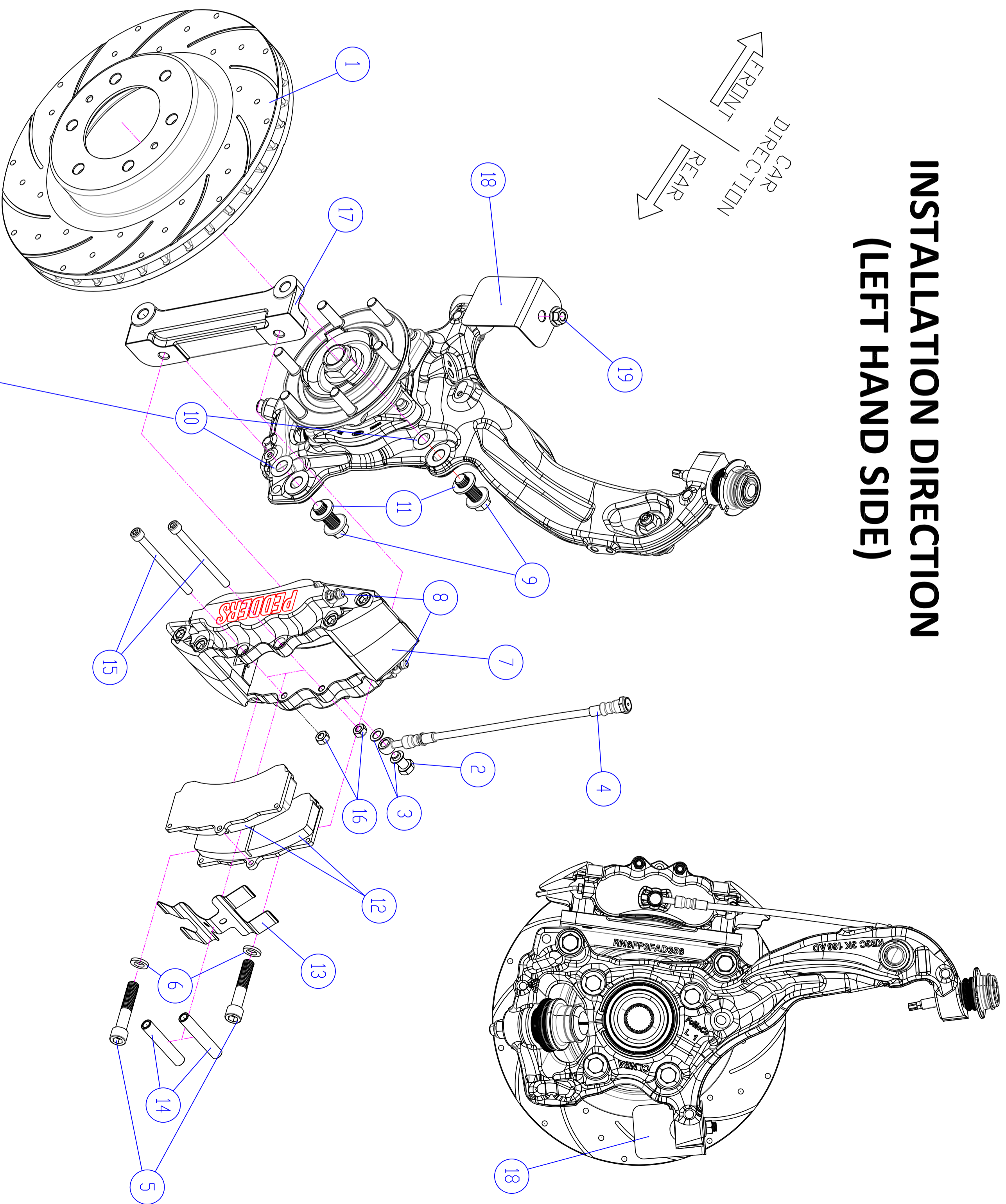

It's recommended to use \*LOCTITE (NO.271) on bolts to fasten bracket and knuckle. \*LOCTITE (NO.271)=Removable/High Strength Thread-locker